

TOTAL MILES
 Township Road System 16.65*
 State Highway System 6.18
 Total 22.83

* Includes ACT 32 Turnback Mileage of .02

- 551 SHOBER ST
- 552 SILVERTON RD
- 553 LLEWELLYN RD
- 554 THIRD ST
- 555 CHURCH ST
- 557 MAIN ST
- 564 DIAMOND ST
- 565 BLACK DIAMOND RD
- 566 GUM BOOT RD
- 568 PHOENIX PARK RD
- 570 BRICKEY ST
- 571 RAILROAD ST
- 572 WILLING ST
- 600 MILL ST
- 601 STEINS MILL RD
- 602 LAWN RD
- 603 OAK ST
- 604 PINE RD
- 605 THIRD AV
- 606 SECOND AV
- 607 FIRST AV
- 608 HILL TERRACE DR
- 610 MAPLE ST
- 611 SPRING ST
- 612 WONDERLAND DR
- 613 SPRINGWOOD AV
- 614 ELM ST
- 615 PINE ST
- 616 WOODLAND DR
- 700 PINE HILL ST
- 701 C ST
- 702 HICKORY ST
- 703 POTTSVILLE ST
- 704 WASHINGTON ST
- 706 KING ST
- 707 COAL ST
- 708 QUEEN ST
- 709 LINE ST
- 710 SNYDER ST
- 711 SPRING ST
- 814 RAMTOWN RD
- 895 BASS LA
- 976 DOWNTOWN RD
- 977 LYTLE ST
- 978 B ST
- 979 MAPLE ST
- 980 A ST
- 981 TAYLOR ST
- 982 CLAY ST
- 983 CHESTNUT ST
- 984 CORNISH ST
- 987 SUNSET DR
- 988 WEST AV
- 989 SUNDAY DR
- 990 LAUDEMANS LA
- 991 LIBERTY DR
- 992 SPRUCE ST
- 993 BARNHART RD
- 994 PEAR ST
- 995 CHERRY LA
- 997 FOURTH AV
- 998 STUB RD

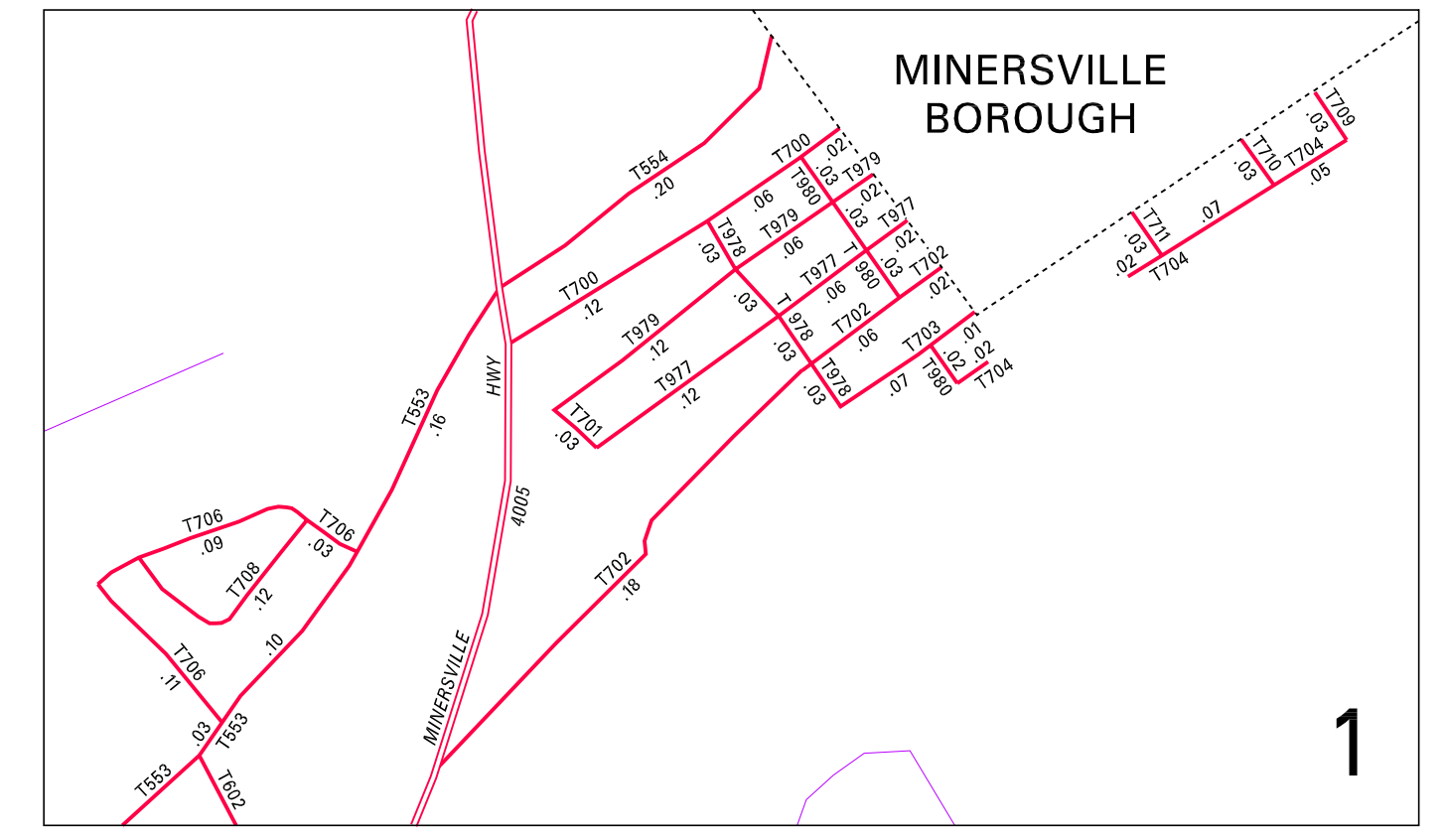
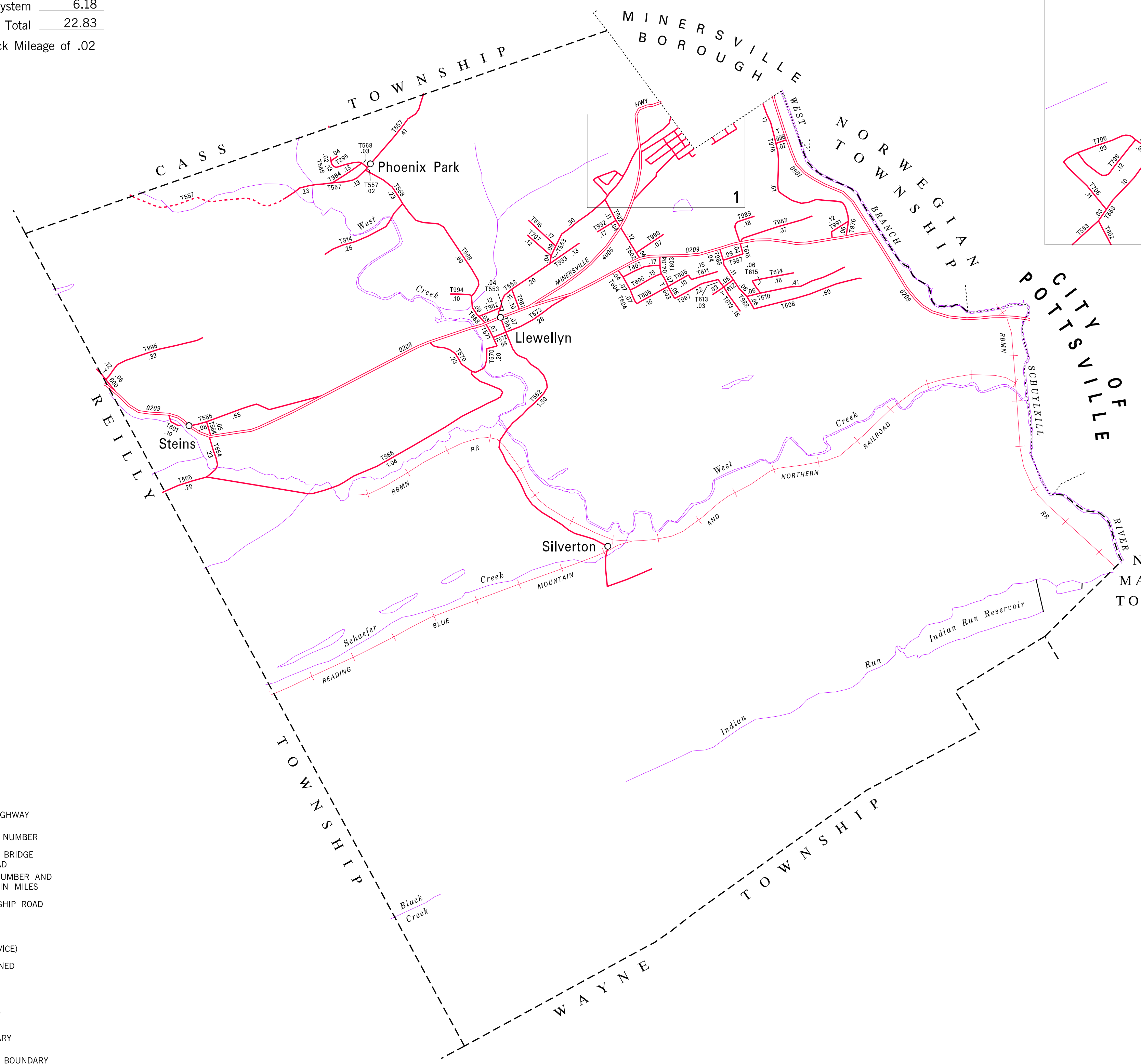

3:1

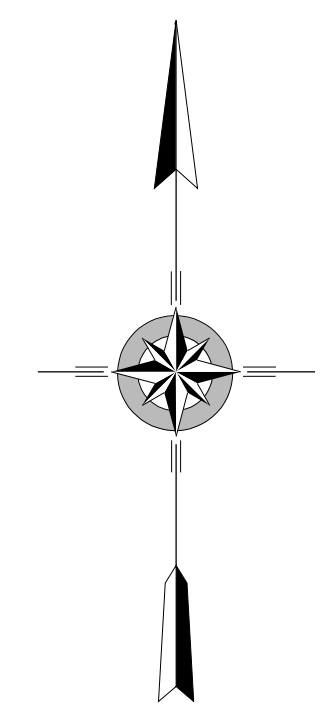

BRANCH
SECOND CLASS TOWNSHIP MAP
 SCHUYLKILL COUNTY

PREPARED BY THE
 PENNSYLVANIA DEPARTMENT OF TRANSPORTATION
 BUREAU OF PLANNING AND RESEARCH
 GEOGRAPHIC INFORMATION DIVISION
 IN COOPERATION WITH THE
 U.S. DEPARTMENT OF TRANSPORTATION
 FEDERAL HIGHWAY ADMINISTRATION
 MUNICIPAL CODE 53 203

REVISED PER FORM 990 DATED 8-25-99

